

Pillow Stand Instruction

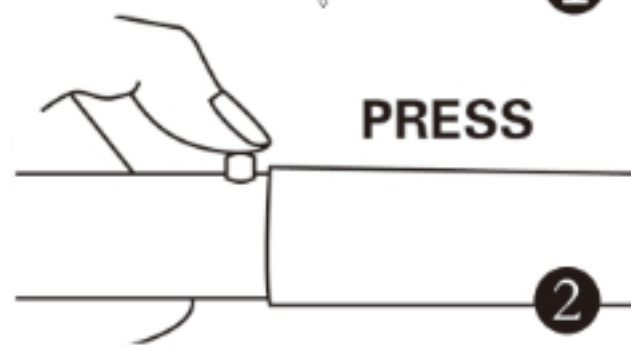

1



2

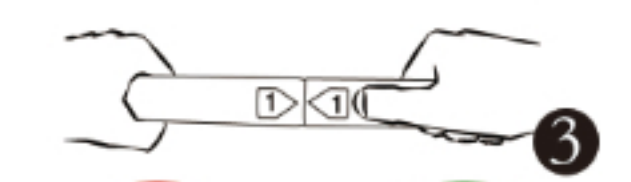

3

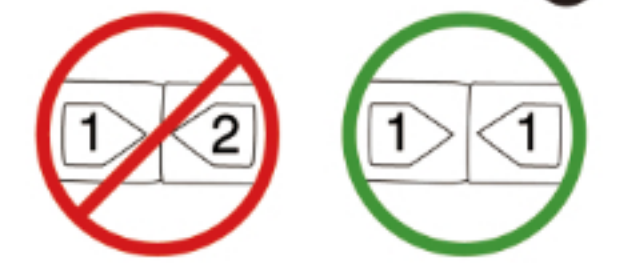

1 Button all tubes first

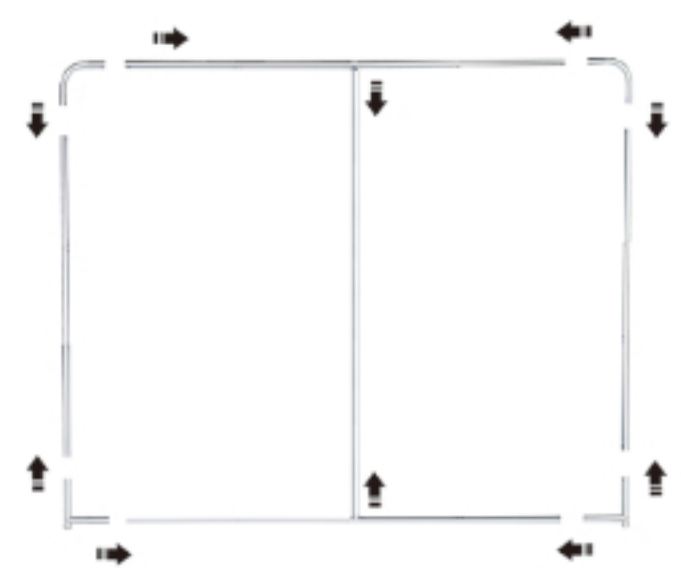

2 Assemble whole frame

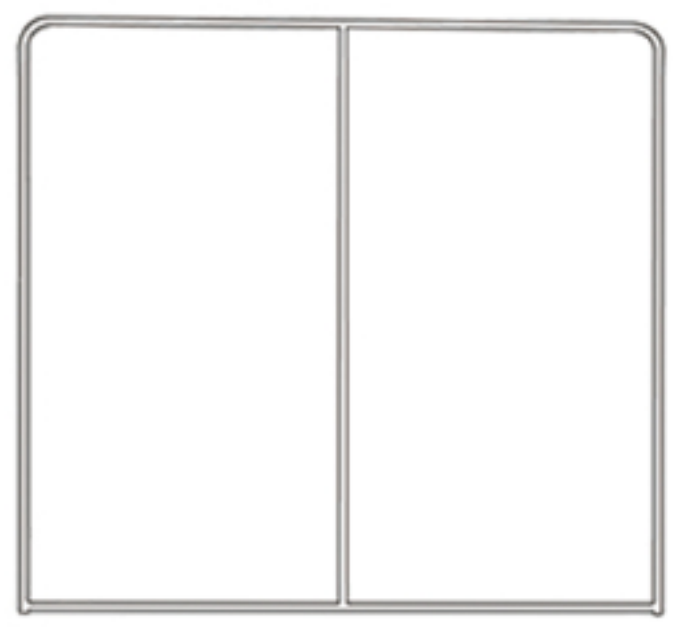

3 Put on the fabric

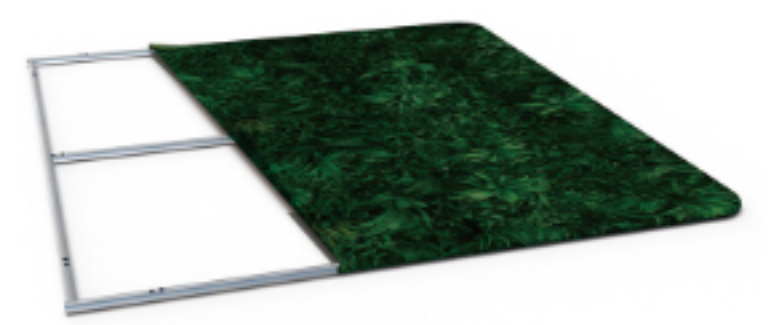

4 Zip the zipper of fabric

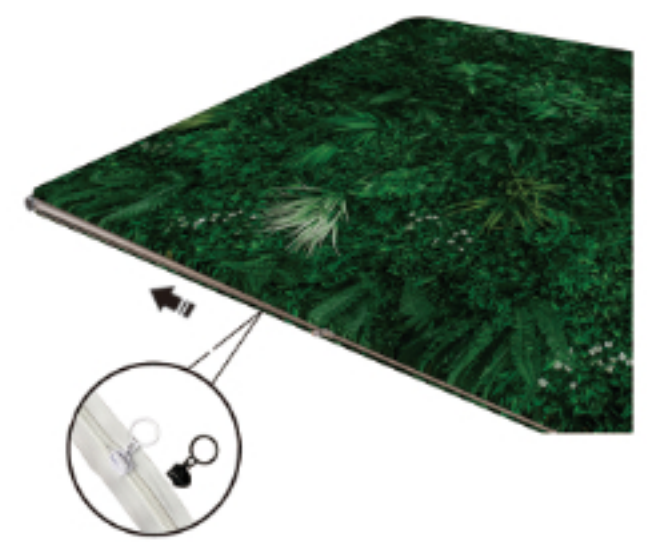

5 Put on both feet

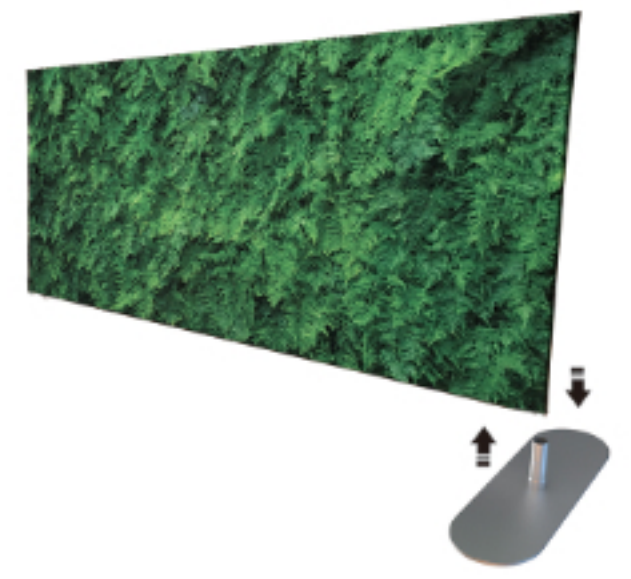

6 Finished Backdrop Stand



CAUTION:
PLEASE READ THE INSTRUCTIONS BEFORE INSTALLING PRODUCT