

# Curved Enclosure Wall

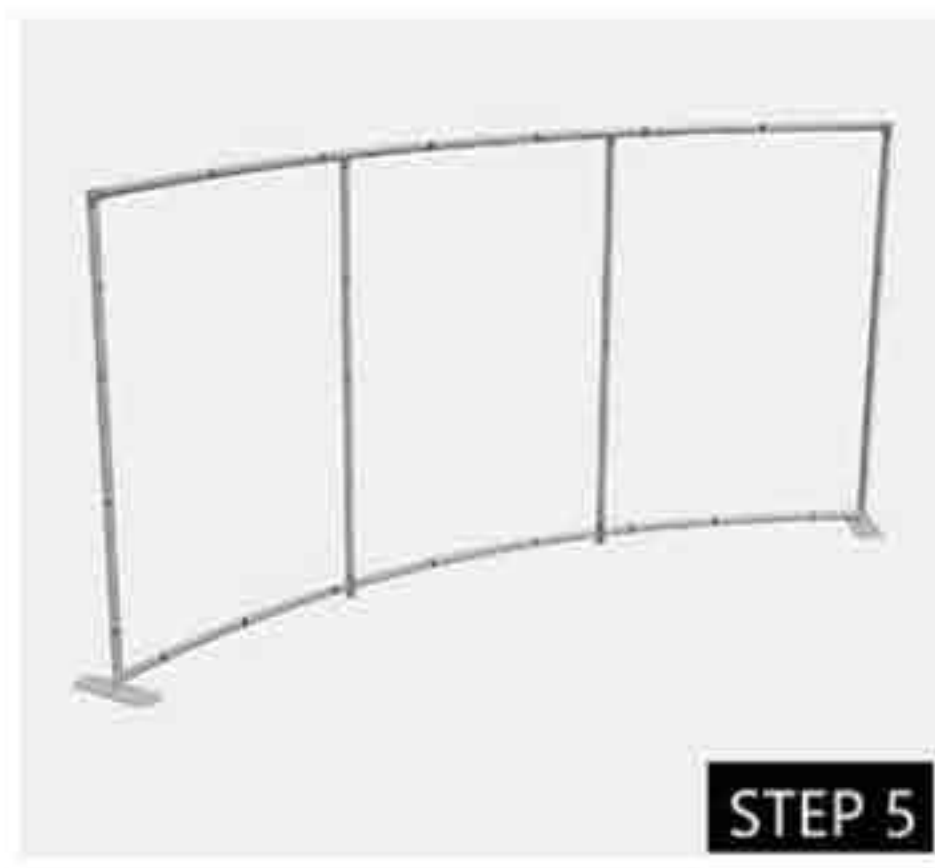

## Instruction Steps

- 00. Peel off tubes' plastic bags and put each bundle of tubes into straight poles
- 01. Aline all poles and parts in numerical order according to tube labels
- 02. Connect parts and poles one by one and finish frame assemble
- 03. Put on its fabric and zip bottom up before put on feet
- 04. Put on feet, stand up the structure, and adjust and make the fabric smooth

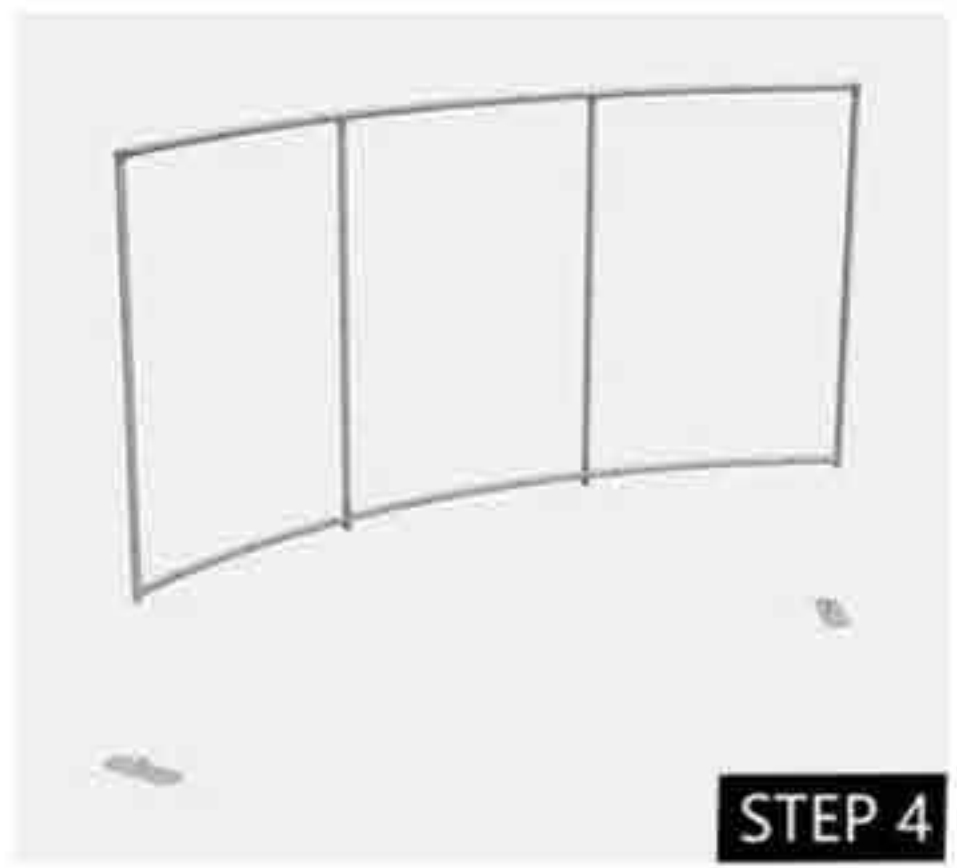
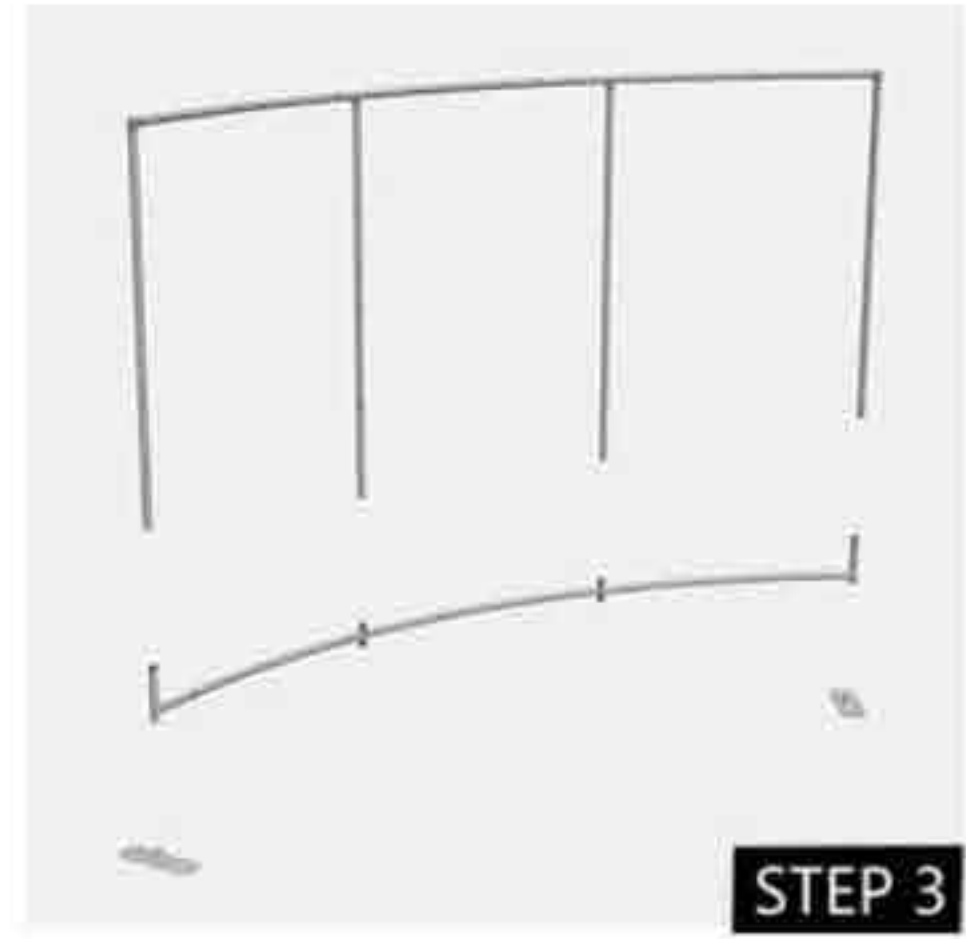
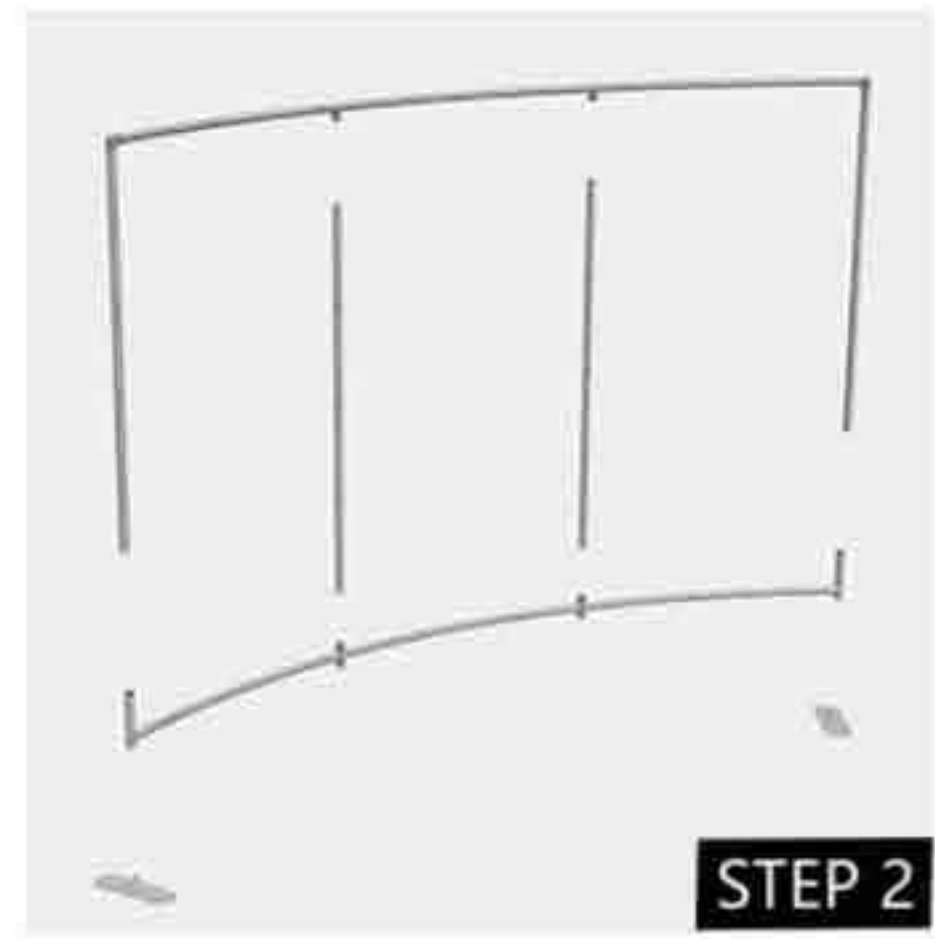
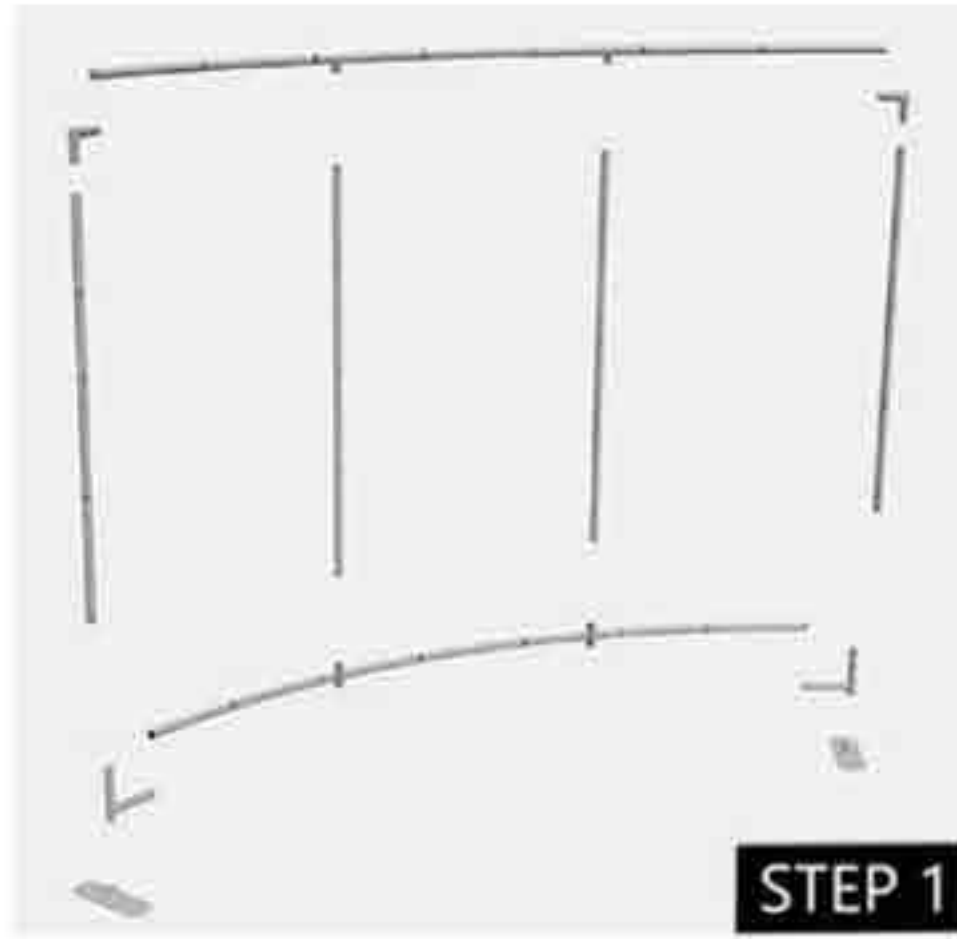
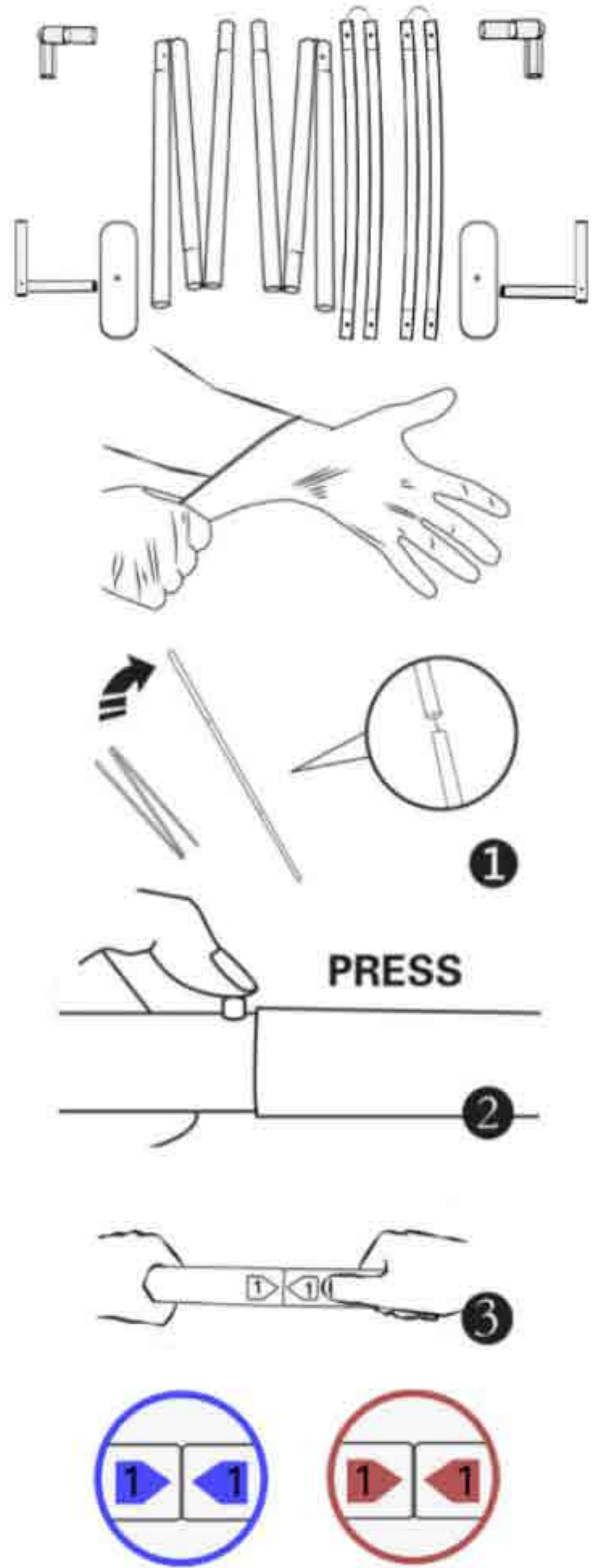

**CAUTION:**  
PLEASE READ THE INSTRUCTIONS BEFORE INSTALLING PRODUCT